

# TANGENTIAL AIR SEPARATORS

## Without Strainer

### FEATURES AND BENEFITS

- ASME constructed and stamped
- 8” and under is 150 PSIG design pressure
- 10” and larger is 125 PSIG design pressure
- MNPT inlet and outlet on 2” and 2 1/2”
- 3” and larger flanged inlet and outlet
- 375° F maximum operating temperature
- Carbon steel construction— primed and painted exterior
- Tangential design results in small unit
- Provides air free fluid flow which protects against damage and system noises
- Higher working pressures, special materials, and/or grooved connections available

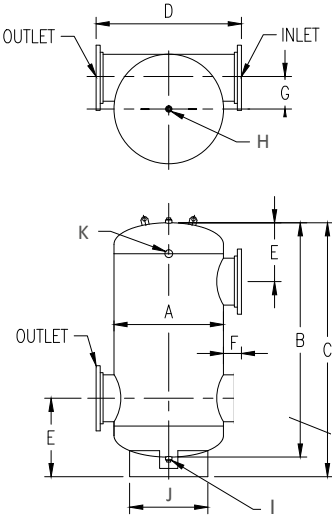

Part No.	Inlet/Outlet	Rated Flow (GPM)	Dimensions in Inches								Clean-Out	NPT - Openings (Inches)			Water Volume	Ship Weight
			A	B	C	D	E	F	G	J		H	I	K		
			Without Strainer & Clean Out													
99028562	2"	80	12	19 1/2	25 1/8	16 5/8	5 1/2	N/A	4 5/16	9 1/2	N/A	1 1/4	1	1/2	10	40
99028563	2.5"	120	12	19 1/2	25 1/9	16 5/8	5 1/2	N/A	4 1/16	9 1/2	N/A	1 1/4	1	1/2	10	44
99028564	3"	210	12	19 1/2	25 1/10	19 3/4	5 3/4	N/A	3 3/4	9 1/2	N/A	1 1/4	1	1/2	10	52
99028565	4"	400	14	29	34 5/8	21 3/4	9 1/8	N/A	4 1/4	11 1/2	N/A	1 1/2	2	1/2	19	94
99028566	5"	600	14	29	34 5/9	21 3/4	9 1/8	N/A	3 3/4	11 1/2	N/A	1 1/2	2	1/2	19	116
98842830	6"	900	20	41	46 5/8	28	13 1/4	N/A	6 1/4	18	N/A	2	2	1/2	56	201
99028567	8"	1,600	20	41	46 5/9	28	13 1/4	N/A	5 3/16	18	N/A	2	2	1/2	56	296
99028568	10"	2,500	30	58	63 9/16	41	19	N/A	9 1/8	24	N/A	2	2	1/2	177	560
99028569	12"	3,600	30	58	63 9/17	41	19	N/A	8 1/8	24	N/A	2	2	1/2	177	665
99028570	14"	4,200	36	75 1/2	80	46 3/8	22	N/A	10 3/16	30	N/A	2	2	1/2	333	910
98933670	16"	5,800	48	100	108	60	30	N/A	12 1/2	38	N/A	2	2	1/2	783	2,200
98933681	18"	7,000	54	116	124	66	33	N/A	13 5/8	44	N/A	2	2 1/2	1/2	1150	2,500
98933682	20"	8,600	60	130	138	72	35	N/A	16	50	N/A	2	2 1/2	1/2	1591	3,800
98933683	24"	12,500	72	152	162	84	40	N/A	19	62	N/A	2	2 1/2	1/2	2679	7,000

# PRESSURE DROP CHART

## AIR SEPARATOR *without strainer*

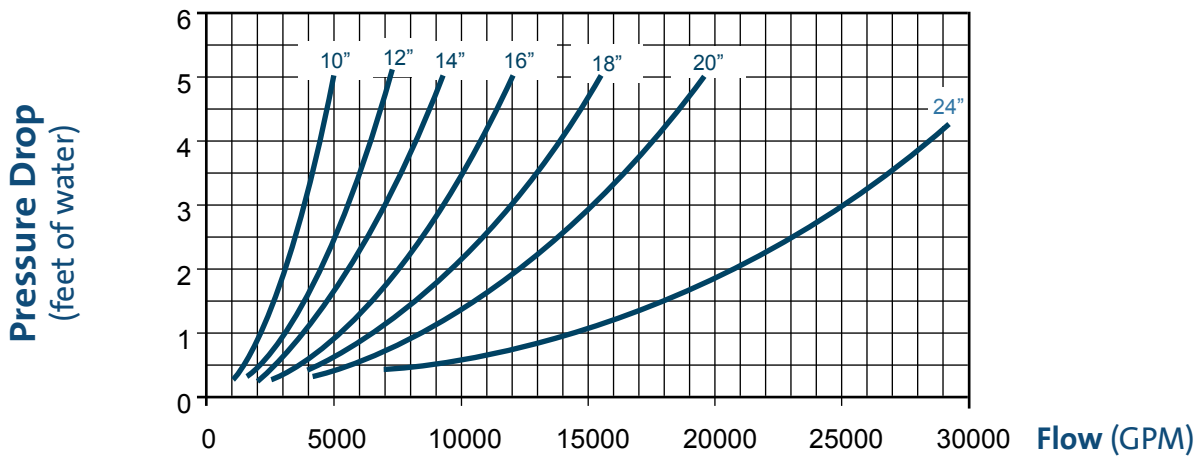
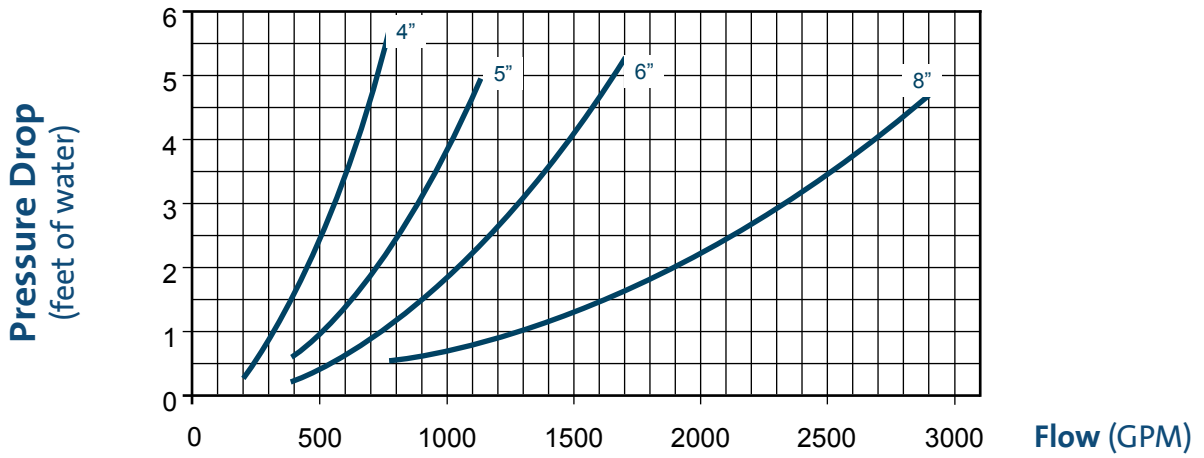
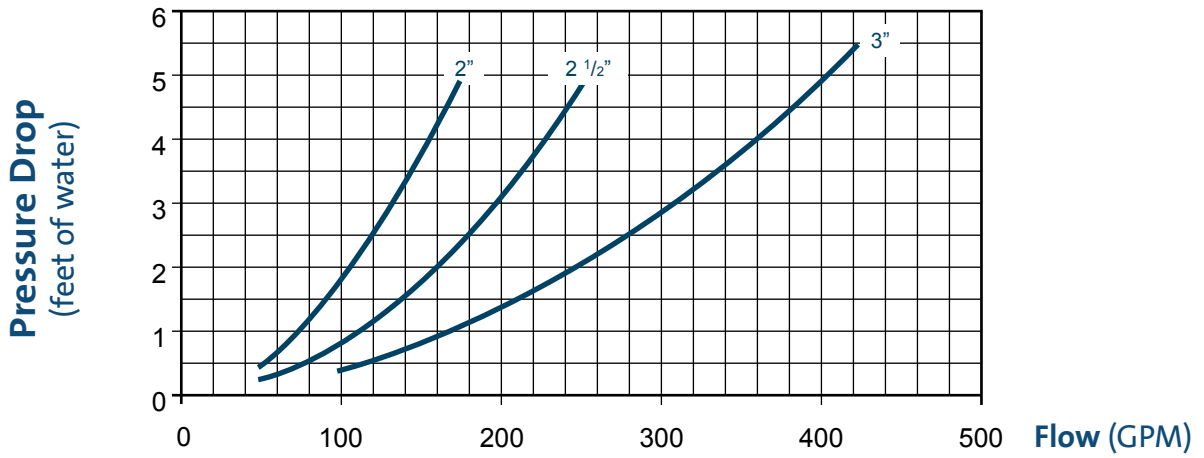

GRUNDFOS  
 902 Koomey Road  
 Brookshire, TX 77423  
 281-994-2700  
 800-955-5847

[www.grundfosexpresssuite.com](http://www.grundfosexpresssuite.com)  
[www.grundfos.us](http://www.grundfos.us)

The name Grundfos, the Grundfos logo, and be think innovate are registered trademarks owned by Grundfos Holding A/S or Grundfos A/S, Denmark. All rights reserved worldwide.

